

Rademaker Family Trust Soils Map

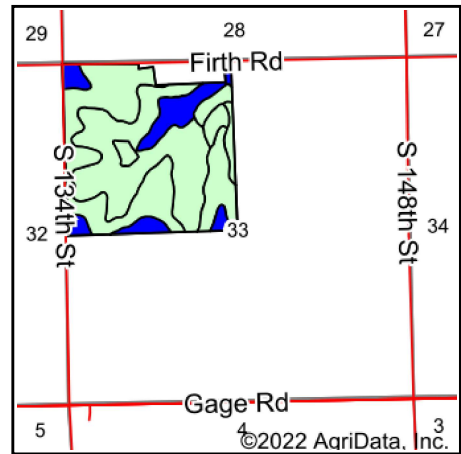

State: **Nebraska**
 County: **Lancaster**
 Location: **33-7N-8E**
 Township: **Panama**
 Acres: **148.3**
 Date: **10/24/2022**

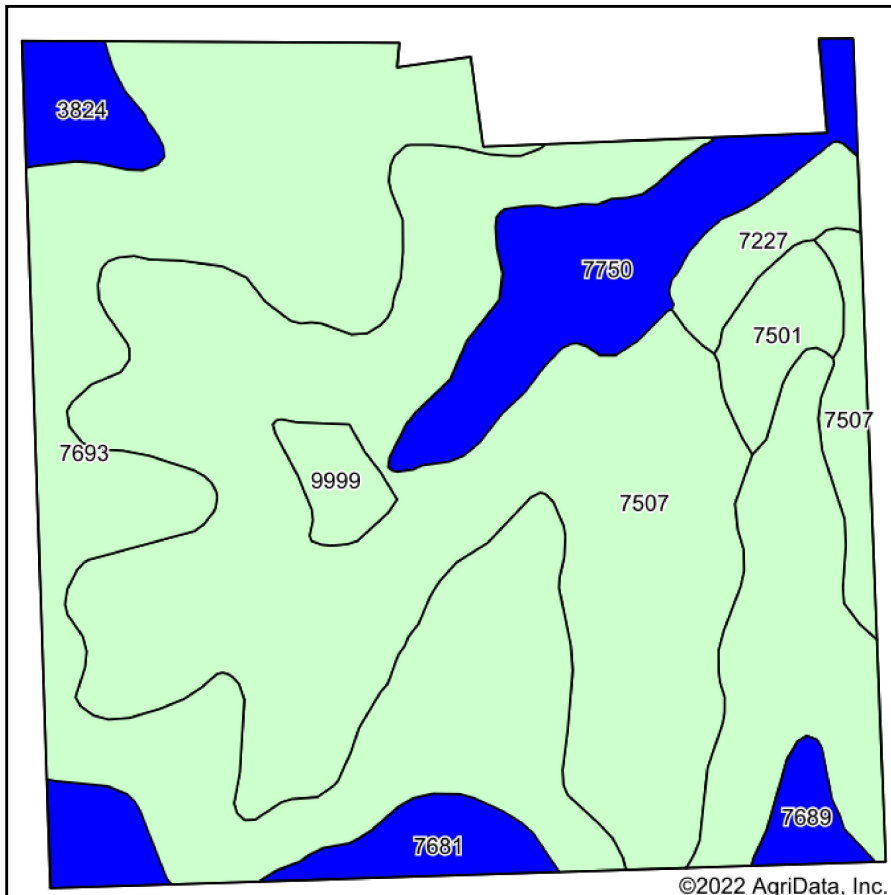

Soils data provided by USDA and NRCS.

Area Symbol: NE109, Soil Area Version: 26

| Code | Soil Description | Acres | Percent of field | Non-Irr Class Legend | Non-Irr Class *c | Irr Class *c | Range Production (lbs/acre/yr) | SRPG | *n NCCPI Soybeans | |
|-------------------------|--|-------|------------------|----------------------|------------------|--------------|--------------------------------|---------------|-------------------|----------------|
| 7507 | Pawnee clay loam, 6 to 11 percent slopes, eroded | 60.01 | 40.5% | | | IVe | 3750 | 58 | 40 | |
| 7693 | Wymore silty clay loam, 2 to 6 percent slopes | 57.71 | 38.9% | | | IIIe | 3750 | 69 | 58 | |
| 7750 | Nodaway silt loam, occasionally flooded | 11.11 | 7.5% | | | IIw | 3150 | 74 | 91 | |
| 7681 | Wymore silty clay loam, 1 to 3 percent slopes | 5.57 | 3.8% | | | Ile | 3800 | 72 | 59 | |
| 7227 | Burchard clay loam, 6 to 11 percent slopes | 3.58 | 2.4% | | | IIIe | 3400 | 68 | 55 | |
| 7501 | Pawnee clay loam, 4 to 8 percent slopes, eroded | 3.31 | 2.2% | | | IIIe | 3878 | | 40 | |
| 3824 | Crete silt loam, 0 to 1 percent slopes | 3.12 | 2.1% | | | IIIs | 3240 | 73 | 64 | |
| 9999 | Water | 2.09 | 1.4% | | | | 0 | 0 | | |
| 7689 | Wymore silty clay loam, 0 to 2 percent slopes | 1.80 | 1.2% | | | IIIs | 3751 | 72 | 61 | |
| Weighted Average | | | | | | *- | | 3637.8 | 62.6 | *n 52.1 |

*n: The aggregation method is "Weighted Average using all components"

*c: Using Capabilities Class Dominant Condition Aggregation Method

*- Non Irr Class weighted average cannot be calculated on the current soils data due to missing data.

*. Irr Class weighted average cannot be calculated on the current soils data due to missing data.

Soils data provided by USDA and NRCS.